

LINEAR LED WIDE FASCIA - LWF

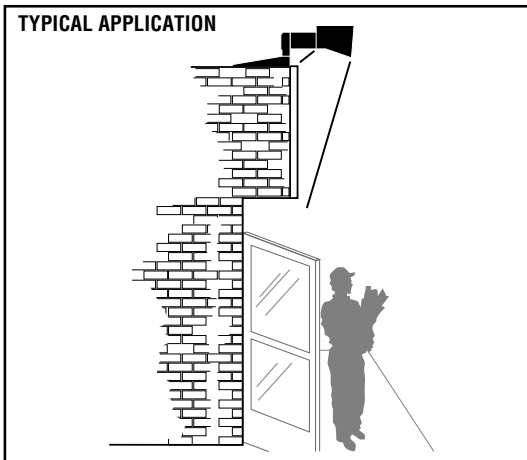

U.S. and international patents pending

APPLICATION - An efficient and easy to install system for constructing continuous row building face lighting from above the top of a fascia. Brilliant High Lux LEDs are designed to provide dramatic and even illumination, for either new or retrofit applications.

LEDS - Select High-brightness LEDs. Available in 4100K (NW) and 5000K (CW). 70 CRI (nominal).

OPTICS - High efficiency, die formed, one piece reflectors provide a smooth and brilliant Asymmetrical distribution along with even vertical illumination to enhance the structure face and create brilliant depth from the road. Incremental optional lengths are designed to seamlessly cover the facade in a continuous row application. Luminaire is rated full cutoff.

LIGHT OUTPUT - Input power is 2.64 watts per foot. Cool White (CW) lumens per foot are 215. Neutral White (NW) lumens per foot are 180.

HOUSING - Die formed, non-corrosive aluminum, painted after fabrication with several powder coat finish options.

POWER SUPPLY - 60w, 120-277V 50/60Hz. IP67 rated for use in wet, damp and dry locations.

OPERATING TEMPERATURE - -35°C to + 60°C (-31°F to +140°F)

INSTALLATION - Installs in continuous row applications designed to span entire fascia and soffit lengths

EXPECTED LIFE - Projected life of 50,000 hours minimum.

WARRANTY - Limited 5-year warranty.

LISTING - UL Listed Wet location

PHOTOMETRICS - Application layouts are available upon request. Contact LSI Applications Group at lighting.apps@lsi-industries.com

DIMENSIONS

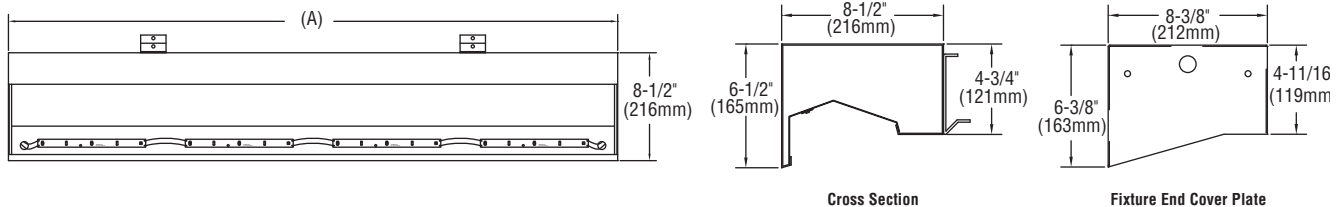

Description	Dim "A"
2' housing	24" / 610mm
4' housing	48" / 1220mm
5' housing	60" / 1524mm
6' housing	72" / 1829mm
8' housing	96" / 2439mm

Dimensions above are for determining overall length of individual sections. Specify total linear run length per individual straight run to insure proper power supply requirements. Standard maximum length of a single unit is 8 feet. All other specified lengths are combinations of 8 feet and below.



Project Name _____ Fixture Type _____
 Catalog # _____

LINEAR LED WIDE FASCIA - LWF

LUMINAIRE ORDERING INFORMATION

TYPICAL ORDER EXAMPLE: **LWF 4 LED CW BLK UE**

Prefix	Total Linear Length Required (ft.)	Light Source	LED Color	Finish ¹	Input Voltage
LWF	2 - 2ft 4 - 4ft 5 - 5ft 6 - 6ft 8 - 8ft 10 - 10ft	LED - Light Emitting Diode	CW - Cool White NW - Neutral White	BRZ - Bronze BLK - Black PLP - Platinum Plus WHT - White GPT - Graphite MSV - Metallic Silver SVG - Satin Verde Green	UE - Universal Input Voltage (120-277V)

NOTE:

- 1- Special RAL colors are available, consult factory for details
- 2- Mounting bracket only available in 8 ft. sections - field cut for shorter lengths

ACCESSORY ORDERING INFORMATION (Accessories are field installed)

Description	Order Number	Description	Order Number
A. Fixture Mounting Bracket ²	BKS-WFBO-WM-96-CLR - 107117CLR	F. Upright Support	43287
B. Bracket End Cap	00069CLR	G. Hat Bracket	52787
C. Fixture End Cap	43148CLR	H. L-Bracket	52993
D. Left Straight Extension	43319CLR	J. Fascia Extension Bracket	5200159
Right Straight Extension	43320CLR	K. Right Hand 2' Miter	5200251CLR
E. Adjustable Outside Corner	43366CLR	L. Left Hand 2' Miter	5200252CLR
Adjustable Inside Corner	43367CLR		

NOTE: CLR- Specify finish. Must be same as luminaire.

